

**Electrical performance:**

- CEI EN 50393 as applicable
- Class 2 in accordance with CEI 64-8.

Gel: UL 94-HB

Working temperature: 90°

Gel operating temperature:  
-60°C / +200°C

Fully submersible

Can be used underground

Halogen-free Gel

UV resistant

Self-extinguishing and resistant to abnormal heat and fire:  
Glow Wire Flammability Index at +960° C according to EN60695-2-12

**IP68**  
OFFICIALLY TESTED

**IMQ**

**IP69K**  
OFFICIALLY TESTED

# FOX BOX

3 or 5 entrance jointing enclosure with gel filled perimeter chamber providing lighter weight with maximum capacity.

Kit includes accessories to maximise versatility allowing the use of cables from 8 to 18 mm in diameter or with 16, 20 and 32 mm diameter cable conduits. The internal, gel-free compartment allows for dry connections or any future alterations or disconnections. The gel, contained in the perimeter chamber also surrounds, insulates and seals any armour continuity connections or cable shields.

## ADVANTAGES

- ▶ Pre-filled with a gel that is not-classified as hazardous under the CLP Directive.
- ▶ Functional, elegant design.
- ▶ Ideal for exposed and safety systems and for video camera installation.
- ▶ Ready for use.
- ▶ Click and hook closure, does not require screws.
- ▶ Ready and installable in all environmental conditions.
- ▶ Also suitable for wet or flooded environments.
- ▶ Always re-enterable.
- ▶ Wall or external ceiling fixing system.
- ▶ No shelf life.

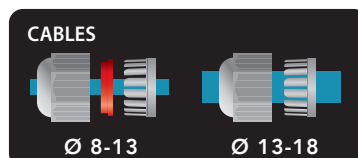

JOINTING BOXES

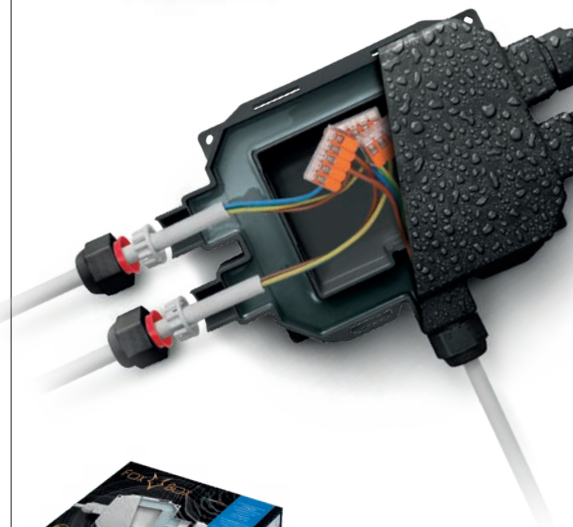
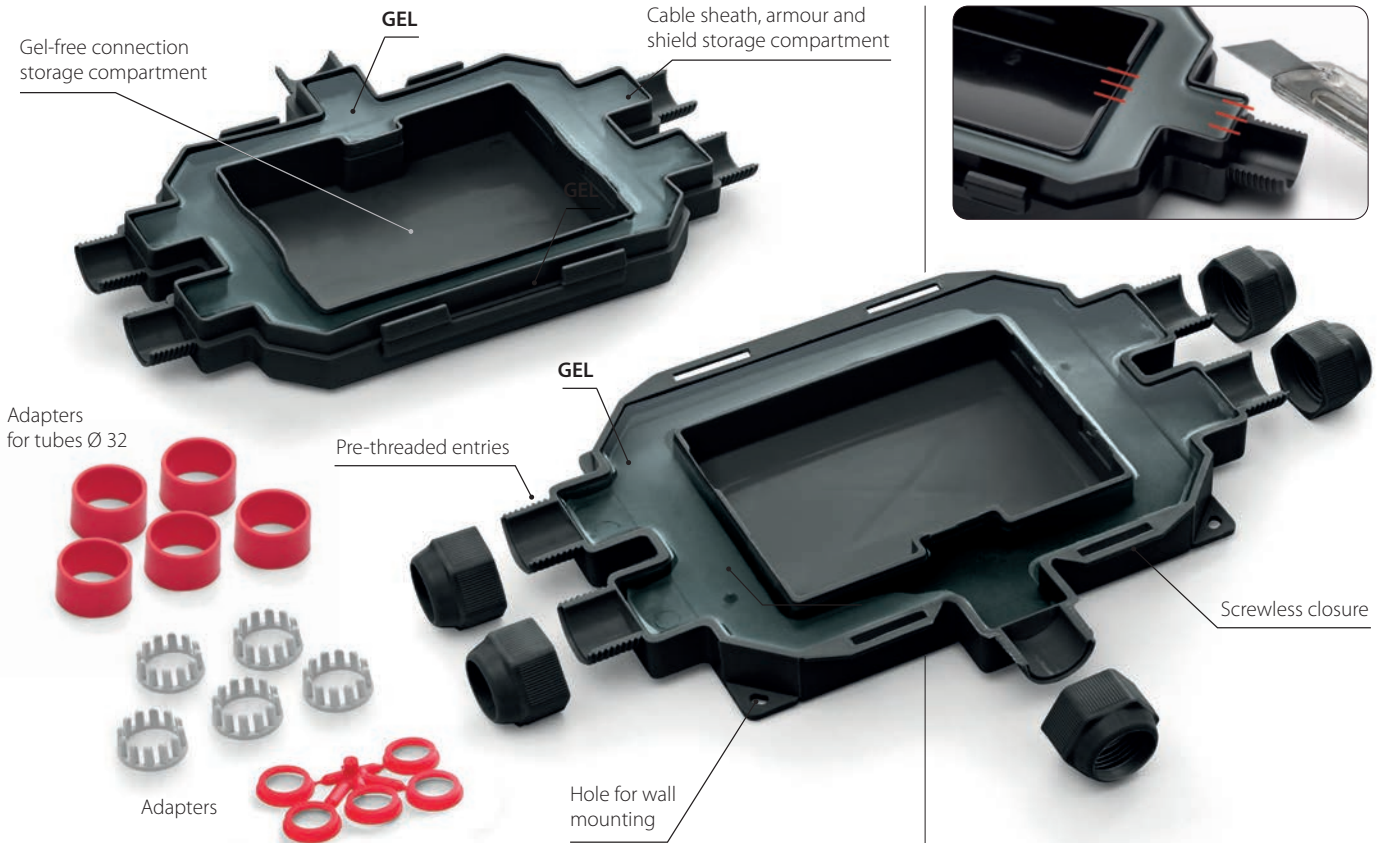

PRODUCT / Item	Colour	Cables Ø min-max (mm)	Tubes Ø (mm)	Inner capacity (mm)	Outer dimensions (mm)
FOX BOX 3 FOXBOX3	●				
FOX BOX 3 - N FOXBOX3-N	●	8 - 18	16 / 20 / 32	79x60x32	180 x 135 x 45
FOX BOX 3 - ARM FOXBOX3-ARM	●				

PRODUCT / Item	Colour	Cables Ø min-max (mm)	Tubes Ø (mm)	Inner capacity (mm)	Outer dimensions (mm)
FOX BOX FOXBOX	●				
FOX BOX - N FOXBOX-N	●	8 - 18	16 / 20 / 32	116 x 78 x 32	210 x 155 x 45
FOX BOX - ARM FOXBOX-ARM	●				

The Fox Box – Arm kit includes:

- The yellow/green insulated wires.
- The roll springs to carry out the continuity of the armoring.

Armourings and their continuity are housed in the chamber with the gel, ensuring perfect sealing.