

STRIPPING TOOLS FOR PRIMARY INSULATION

IMS – Cable Stripper for Primary Insulation

APPLICATION RANGE	25 - 240 mm ²
INSULATION THICKNESS	Preadjusted stripping inserts
SUGGESTED APPLICATION	Any type of primary insulation

Technical Characteristics:

- Suitable for MV cables 10/11kV or 20/22kV
- Stripping length adjustable from 20 to 100mm using the device built into the handle
- Scale marked on the handle to display the preset stripping length
- Handle with bayonet connection
- Cutting direction indicated by an arrow on the insert
- Interchangeable blade

Inserts available:

10 - 11kV

- Insert for 35 mm² 1716021
- Insert for 50 mm² 1716024
- Insert for 120 mm² 1716013
- Insert for 150 mm² 1716027
- Insert for 185 mm² 1716020
- Insert for 240 mm² 1716006

20 - 22kV

- Insert for 25 mm² AV63025
- Insert for 35 mm² AV63035
- Insert for 50 mm² AV63050
- Insert for 70 mm² AV63070
- Insert for 95 mm² AV63095
- Insert for 120 mm² AV63120
- Insert for 150 mm² AV63150
- Insert for 185 mm² AV63185
- Insert for 240 mm² AV63240

Other inserts available on request (10kV, 30kV, customized sizes), by sending PE-Coating ϕ and Conductor ϕ in mm

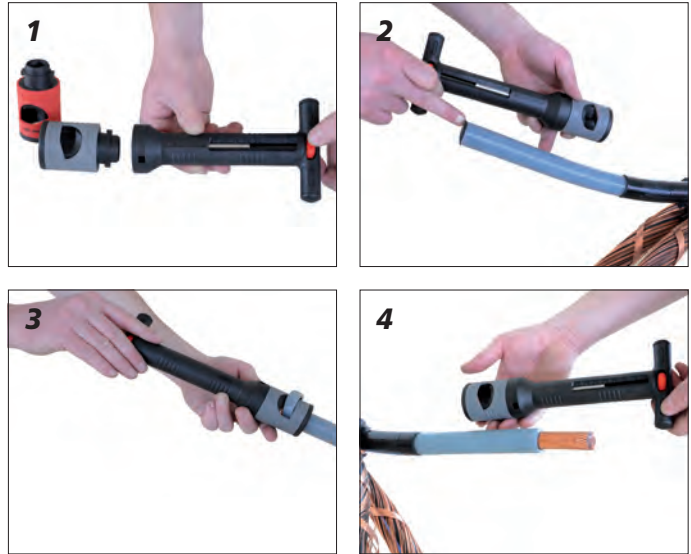

- EASY HANDLING THROUGH PREADJUSTED INSERTS
- ADJUSTABLE STRIPPING LENGTH
- DESIGNED TO WORK IN LIMITED SPACE

Description	Order No.	Dimensions	Weight
Set: IMS 20kV	AV6310	330 x 290 x 75 mm	600 g
Set: IMS 20kV + AMS	AV6320	330 x 290 x 75 mm	1,70 kg
Spare blade	AV6399	-	-

Attention: not suitable for work under voltage

SET Equipment - AV6310:

- Handle AV6300
- Stripping inserts 25, 35, 50, 70, 95, 120, 150, 185, 240mm²
- Rigid plastic case AB6300

SET Equipment - AV6320 like model AV6310 including:

- AMS - cable stripper AV6221



Norm: EN10020

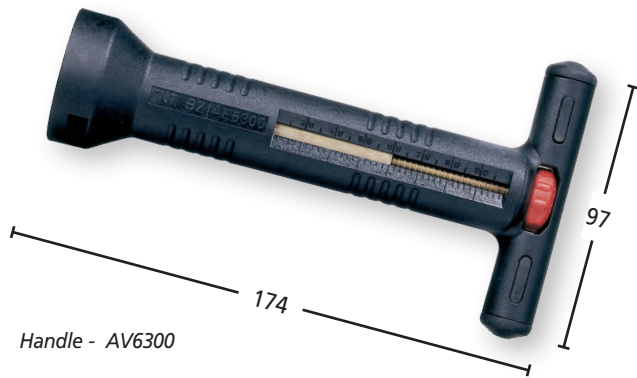

Handle - AV6300

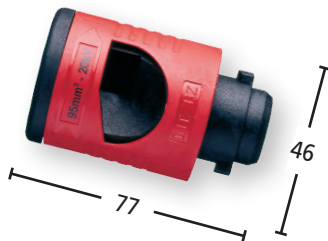

Stripping insert - AV63...



IMS 20kV-Set – AV6310